



REGIO

Advanced Toilet Technology From Japan





REGIO

LIXIL proudly offers this Luxury Toilet to the world

LIXIL
DESIGNING
SMART

In all that we create; we care about the quality of your everyday life. We aim for a harmonious marriage of beauty and comfort. We are committed to designing smart, not just for today, but lasting beyond tomorrow. By designing smart we mean our uncompromising commitment to aesthetics that will unobtrusively beautify your home and perform beyond your expectations.

LIXIL has created the total solution for living spaces and has earned the trust of its customers by offering sophisticated design and technology solutions that complement exquisite lifestyles. Sublime quality and superior designs are infused into the bathroom through an array of toilets, advanced toilet seats, and integrated toilets.



THE REGIO COMBINES POWER AND QUIET TO CREATE THE INDUSTRY'S FIRST "SILENT STREAM FLUSHING SYSTEM"

The REGIO's flush is 10% quieter than a conventional toilet.



AIR-DRIVE

The strength of water and air unite to create a quite, yet powerful, flush.
You'll hear little more than the sound of a murmuring brook.

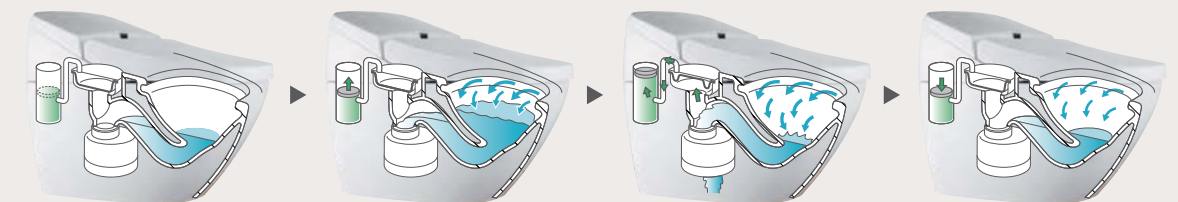

※Sound level during flushing may vary depending on plumbing conditions.



AUTOMATIC TOILET

The REGIO has multiple features and technologies.



AUTOMATIC

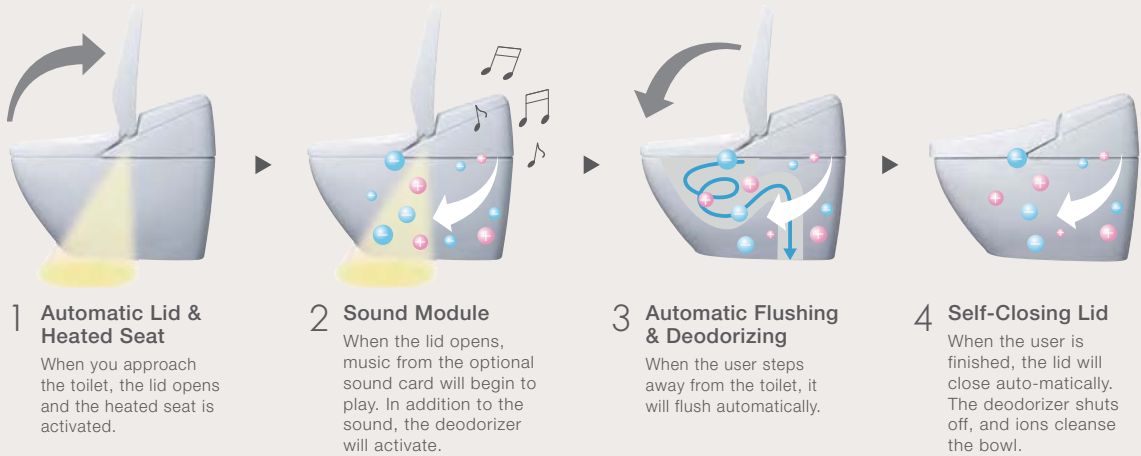

Automatic Functions



Fully automatic toilet seat system
A sensor detects your presence, and automatically opens (and closes) the lid.



Fully automatic flushing action
When the user steps away from the toilet, it flushes automatically.



Two Stage Deodorizing
When the user sits on the seat, the deodorizing begins.



Energy Saver
When the toilet is not in use, the power consumption is reduced, thereby saving energy.



COMFORT TECHNOLOGY

LIXIL toilets offer improved functions for a more pleasant space.



Comfort Functions



Relaxing Music
Soft music plays automatically for a relaxing and comfortable environment.



Plasmacluster Technology
Plasmacluster technology cleans the air with antibacterial ions.



Soft Light
A sensor illuminates the area both inside the bowl and at the user's feet.

HYGIENIC CLEANSING

Front and rear cleansing for refreshing comfort, and a feeling of clean like never before.



Posterior Washing
Rinses you with warm water and it is more comfortable than using paper.

Cleansing Functions



Two Separate Nozzles
LIXIL shower toilets are equipped with dedicated front and rear cleansing nozzles.



Front Cleansing
Warm water is infused with air to provide a soothing shower that's gentle enough for a woman's delicate areas.



Rear Cleansing
The REGIO offers two rear cleansing modes: One for a stronger, more direct spray, and another for a gentle, broad-based spray.



Massage
The spray alternates between strong and mild, creating a massaging effect for the user.

EASY TO CLEAN

A variety of stain-repellant surface technologies make cleaning a snap.



Cleaning Functions



Silent Stream Flush
This new system combines the power of water and air to achieve a flush both quiet and strong. The sound level during flushing may vary, depending on plumbing conditions.



Proguard
Bacteria and mildew can't adhere to the surface of the bowl, keeping the toilet bowl clean.



Unique Bowl Design
The REGIO's bowl design cleans the bowl with every flush.



Hyper Clean
An exceptionally smooth and hard surface created by LIXIL ensures easy cleaning.



REGIO

Noble Black

*Black model has a white inner bowl for easy cleaning.



Brilliant White



OPTION

Remote Control Stand



Standard Type Specification

			REGIO	
Toilet Bowl			GBC-R10S(300)-W/BKG	GBC-R10S(300)-W/BW1
Seat Unit			DV-R115-VH-W/BKG	DV-R115-VH-W/BWG
Operating Pressure Range			0.1 (flow pressure) – Maximum water pressure 0.75 (hydrostatic pressure) MPa	
Rated power			220 V, 230 V, 240 V, 50 Hz	
Rated power consumption			700 W	
Flush Volume			6 L for full flush, 4 L for partial flush, and 4 L for urination by male	
Product dimensions			460 mm (W) x 775 mm (D) x 610 mm (H)	
Product weight			Approx. 64 kg (approx. 14 kg for the function unit and approx. 50 kg for the toilet)	
Wall-mounted controller			257mm (W) x 25mm (D) x 80mm (H)	
			2 AA batteries	
Clock accuracy			Within +/-1 minute per month at room temperature (25°C)	
Cleansing	Water heater capacity		Hot water storage type: Approx. 2 L	
	Spray Volume	Power cleansing	0.65 – 1.4 L/min (adjustable to 6 levels)	
		Mild cleansing	0.45 – 0.9 L/min (adjustable to 6 levels)	
	Feminine cleansing spray volume		0.8 – 1.5 L/min (adjustable to 6 levels)	
	Water supply method		Direct connection with tap water	
	Water heater capacity		600 W	
	Adjustable water temperature		OFF (water temperature) and adjustable to 6 levels within the range from Low (approx. 32°C) to High (approx. 40°C)	
Safety device			Temperature fuse, high-temperature sensor switch, and float switch	
Dryer	Air flow		0.3 m³/min (DC sirocco fan: 12 VDC)	
	Air heater capacity		380 W	
	Adjustable warm air temperature		Low (room temperature) , Mid, and High (thermistor control)	
Toilet seat, lid	Safety device		Temperature fuses (2)	
	Heater capacity		48 W	
	Surface temperature		OFF (room temperature) and within the range from Low (approx. 28°C) to High (approx. 40°C)	
	Adjustable seat temperature		Adjustable to 6 levels (with microcomputer control and seat heater auto OFF function) (thermistor control)	
	Safety device		Temperature fuse	
Deodorizer	Deodorizing method		Chemical absorption by deodorizer cartridge	
	Cartridge life time		Approx. 7 years	
	Deodorizing capacity		Power mode: 0.11 m³/min, Full-power mode: 0.14 m³/min, Turbo mode: 0.17 m³/min	
	Fan type		Sirocco fan	
Plasmacluster	Filter		Built into the top cover	
	Air flow		0.3m³/min	
	Fan type		Sirocco fan	
	Antibacterial ion operation mode		Automatic switch between clean mode and refresh mode	
	Filter		Built into the top cover	
Music play	No. of music tracks		29	
	Output		0.25 W x 2 (stereo)	
	Speaker		2 W	
	Memory		SD memory card	
	Music data compression method		MP3	
Power save			Advanced power save (power save for 24 hours) , one-touch power save (automatically reset the power save status after 8 hours)	
Sensor			Occupied seat sensor: Infrared distance-measuring sensor Body sensor: Infrared distance-measuring sensor	
Power cord			Effective length: 1.0 m	
Operating temperature range			0°C – 40°C	
Option / Remote Control Stand			FKF-20M	

CB Certification

Installation Drawing

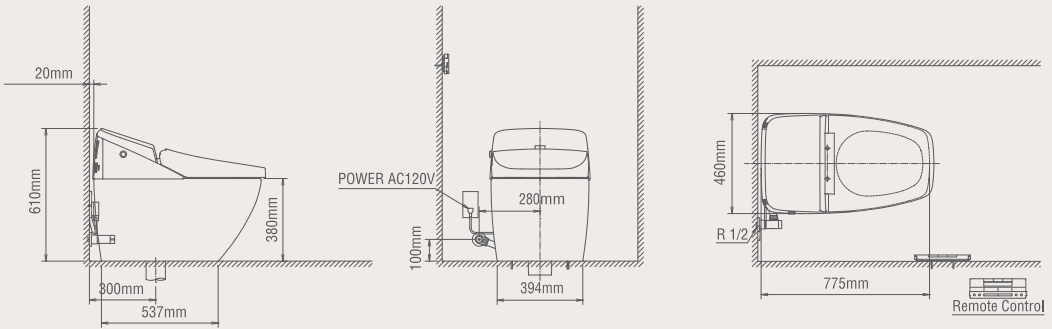

North America Market Specification

			REGIO			
Set Product Number			D-R115-VL-US/BKG		D-R115-VL-US/BWG	
Toilet Bowl			GBC-R10S(300)-US/BKG		GBC-R10S(300)-US/BW1	
Seat Unit			DV-R115-VL-US/BKG		DV-R115-VL-US/BWG	
Operating Pressure Range			14.5psi(0.1MPa) (flow pressure)-Maximum water pressure 108.8psi(0.75MPa) (hydrostatic pressure)			
Rated power			120 VAC, 60 Hz			
Rated power consumption			700 W			
Flush Volume			1.6 GPF (6 L) (Full Flush) , 1.1 GPF (4 L) (Partial Flush)			
Product dimensions			18 -1/8" (460 mm) (W) × 30 -1/2" (775 mm) (D) × 24" (610 mm) (H)			
Product weight			approx.141.1 lbs (64 kg) Seat unit : approx.30.9 lbs (14 kg),Toilet unit : 110.2 lbs (50 kg)			
Wall-mounted controller			10 -1/8" (257 mm) × 1" (25 mm) × 3 -1/8" (80 mm)			
			2 AA batteries			
Clock accuracy			Within +/-1 minute per month at room temperature (87°F) (25°C)			
Cleansing	Water heater capacity		0.53 gal (2 L)			
	Spray Volume	Power cleansing	0.17 - 0.37 GPM (0.65-1.4 L/min)			
		Mild cleansing	0.12 - 0.24 GPM (0.45-0.9 L/min)			
	Feminine cleansing spray volume		0.21 - 0.40 GPM (0.8-1.5 L/min)			
	Water supply method		Direct connection with tap water			
	Water heater capacity		600 W			
Dryer	Adjustable water temperature		OFF (water temperature)and adjustable to 6 levels within the range from Low (approx. 90°F (32°C)) to High (approx. 104°F (40°C))			
	Safety device		Temperature fuse, high-temperature sensor switch, and float switch			
	Air flow		10.5CFM(0.3m³/min) (DC sirocco fan:12VDC)			
	Air heater capacity		380 W			
Toilet seat, lid	Adjustable warm air temperature		Low (room temperature) , Mid, and High (thermistor control)			
	Safety device		Temperature fuses (2)			
	Heater capacity		48 W			
	Surface temperature		OFF (room temperature) and within the range from Low (approx. 82°F (28°C)) to High (approx. 104°F (40°C))			
	Adjustable seat temperature		Adjustable to 6 levels (with microcomputer control and seat heater auto OFF function) (thermistor control)			
Deodorizer	Safety device		Temperature fuse			
	Deodorizing method		Chemical absorption by deodorizer cartridge			
	Cartridge life time		Approx. 7 years			
	Deodorizing capacity		Power Mode : 3.9 CFM (0.11 m³/min), Full-power mode : 4.9 CFM (0.14 m³/min), Turbo mode : 6.0 CFM (0.17 m³/min)			
Plasmacluster	Fan type		Sirocco fan			
	Filter		Built into the top cover			
	Air flow		10.5 CFM (0.3 m³/min)			
	Fan type		Sirocco fan			
Music play	Antibacterial ion operation mode		Automatic switch between clean mode and refresh mode			
	Filter		Built into the top cover			
	No. of music tracks		29			
	Output		0.25 W × 2 (stereo)			
	Speaker		2 W			
	Memory		SD memory card			
	Music data compression method		MP3			
	Power save		Advanced power save(power save for 24 hours) , one-touch power save(automatically reset the power save status after 8 hours)			
Sensor			Occupied seat sensor: Infrared distance-measuring sensor Body sensor: Infrared distance-measuring sensor			
Power cord			3ft (1.0 m)			
Operating temperature range			32-104°F (0°C - 40°C)			
Option / Remote Control Stand			FKF-20M-US			

Installation Drawing

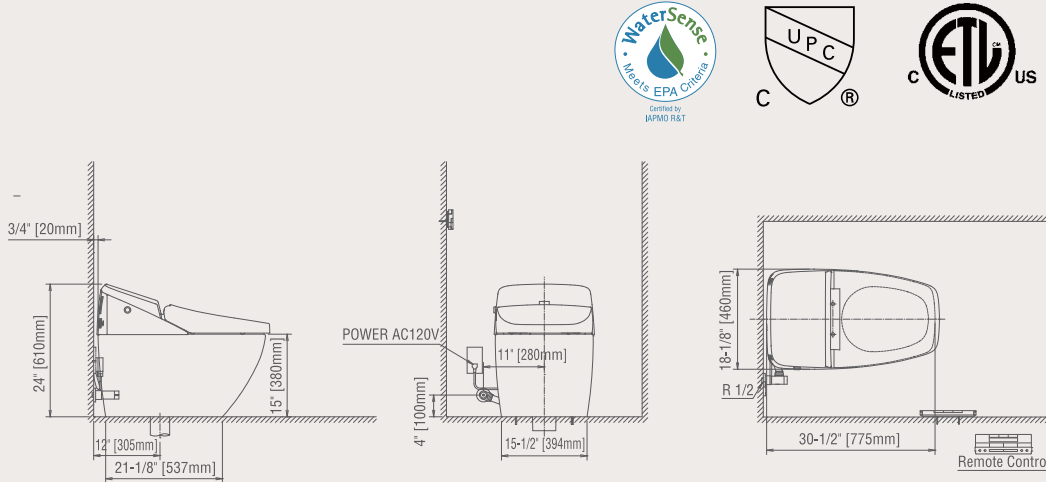

Taiwan Market Specification

			REGIO	
Toilet Bowl			GBC-R10S(300)-TW/BKG	GBC-R10S(300) -TW/BW1
Seat Unit			DV-R115-VL-TW/BKG	DV-R115-VL-TW/BWG
Operating Pressure Range			0.1 (flow pressure) – Maximum water pressure 0.75 (hydrostatic pressure) MPa	
Rated power			AC110 V, 60 Hz	
Rated power consumption			700 W	
Flush Volume			6 L for full flush, 5 L for partial flush, and 5 L for urination by male	
Product dimensions			460 mm (W) x 775 mm (D) x 610 mm (H)	
Product weight			Approx. 64 kg (approx. 14 kg for the function unit and approx. 50 kg for the toilet)	
Wall-mounted controller			257mm (W) x 25mm (D) x 80mm (H)	
			2 AA batteries	
Clock accuracy			Within +/-1 minute per month at room temperature (25°C)	
Cleansing	Water heater capacity		Hot water storage type: Approx. 2 L	
	Spray Volume	Power cleansing	0.65 – 1.4 L/min (adjustable to 6 levels)	
		Mild cleansing	0.45 – 0.9 L/min (adjustable to 6 levels)	
	Feminine cleansing spray volume		0.8 – 1.5 L/min (adjustable to 6 levels)	
	Water supply method		Direct connection with tap water	
	Water heater capacity		600 W	
	Adjustable water temperature		OFF (water temperature) and adjustable to 6 levels within the range from Low (approx. 32°C) to High (approx. 40°C)	
Dryer	Safety device		Temperature fuse, high-temperature sensor switch, and float switch	
	Air flow		0.3 m³/min (DC sirocco fan: 12 VDC)	
	Air heater capacity		380 W	
	Adjustable warm air temperature		Low (room temperature) , Mid, and High (thermistor control)	
	Safety device		Temperature fuses (2)	
	Heater capacity		48 W	
	Surface temperature		OFF (room temperature) and within the range from Low (approx. 28°C) to High (approx. 40°C)	
Toilet seat, lid	Adjustable seat temperature		Adjustable to 6 levels (with microcomputer control and seat heater auto OFF function) (thermistor control)	
	Safety device		Temperature fuse	
Deodorizer	Deodorizing method		Chemical absorption by deodorizer cartridge	
	Cartridge life time		Approx. 7 years	
	Deodorizing capacity		Power mode: 0.11 m³/min, Full-power mode: 0.14 m³/min, Turbo mode: 0.17 m³/min	
	Fan type		Sirocco fan	
Plasmacluster	Filter		Built into the top cover	
	Air flow		0.3m³/min	
	Fan type		Sirocco fan	
	Antibacterial ion operation mode		Automatic switch between clean mode and refresh mode	
	Filter		Built into the top cover	
Music play	No. of music tracks		29	
	Output		0.25 W x 2 (stereo)	
	Speaker		2 W	
	Memory		SD memory card	
	Music data compression method		MP3	
Power save			Advanced power save(power save for 24 hours) , one-touch power save(automatically reset the power save status after 8 hours)	
Sensor			Occupied seat sensor: Infrared distance-measuring sensor Body sensor: Infrared distance-measuring sensor	
Power cord			Effective length: 1.0 m	
Operating temperature range			0°C – 40°C	
Option / Remote Control Stand			FKF-20M	

Installation Drawing

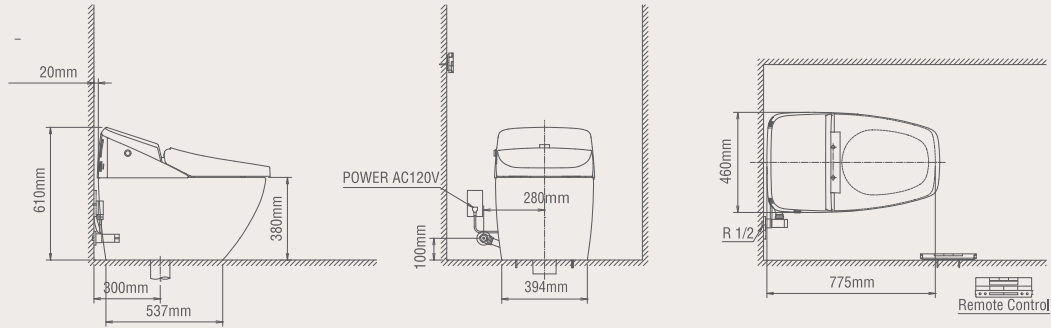



LIXIL Corporation

<http://global.lixil.co.jp/>

JAPAN OFFICE:

11F Kasumigaseki Building, 3-2-5 Kasumigaseki, Chiyoda-ku,
Tokyo, 100-6011, JAPAN

TEL: +81-3-6273-3255 FAX: +81-3-6273-3281

U.S.A. <California>

TEL: +1-424-237-1031 FAX: +1-424-237-1036

<http://www.inax-usa.com/>

KOREA <Seoul>

TEL: +82-2-512-6905 FAX: +82-2-512-6927

<http://www.inaxkorea.co.kr/>

TAIWAN <Taipei>

TEL: +886-2-2826-5888 FAX: +886-2-2826-5688

<http://www.inax.com.tw/>

CHINA <Shanghai>

TEL: +86-21-6334-3366 FAX: +86-21-6473-2360

<http://www.lixil.cn/>

VIETNAM

<Hanoi>

TEL: +84-4-3556-6153 FAX: +84-4-3556-6031

<Ho Chi Minh>

TEL: +84-8-3846-0916 FAX: +84-8-3846-0905

<http://inax.com.vn/>