

# Contour 21+ – Washbasin

Armitage  
Shanks

## Product

S0430HY - Basin

S038667 - Waste Pack

S038867 - Fixing Set

## Description

'Contour 21+' vitreous china wall mounted washbasin without taphole nor overflow hole, back outlet, with Hydrofin anti-splash design, anti-microbial glazed SmartGuard surface, white colour, with waste pack connection with 75mm water seal, with anti-microbial SmartGuard surface, with basin fixation set for panels.

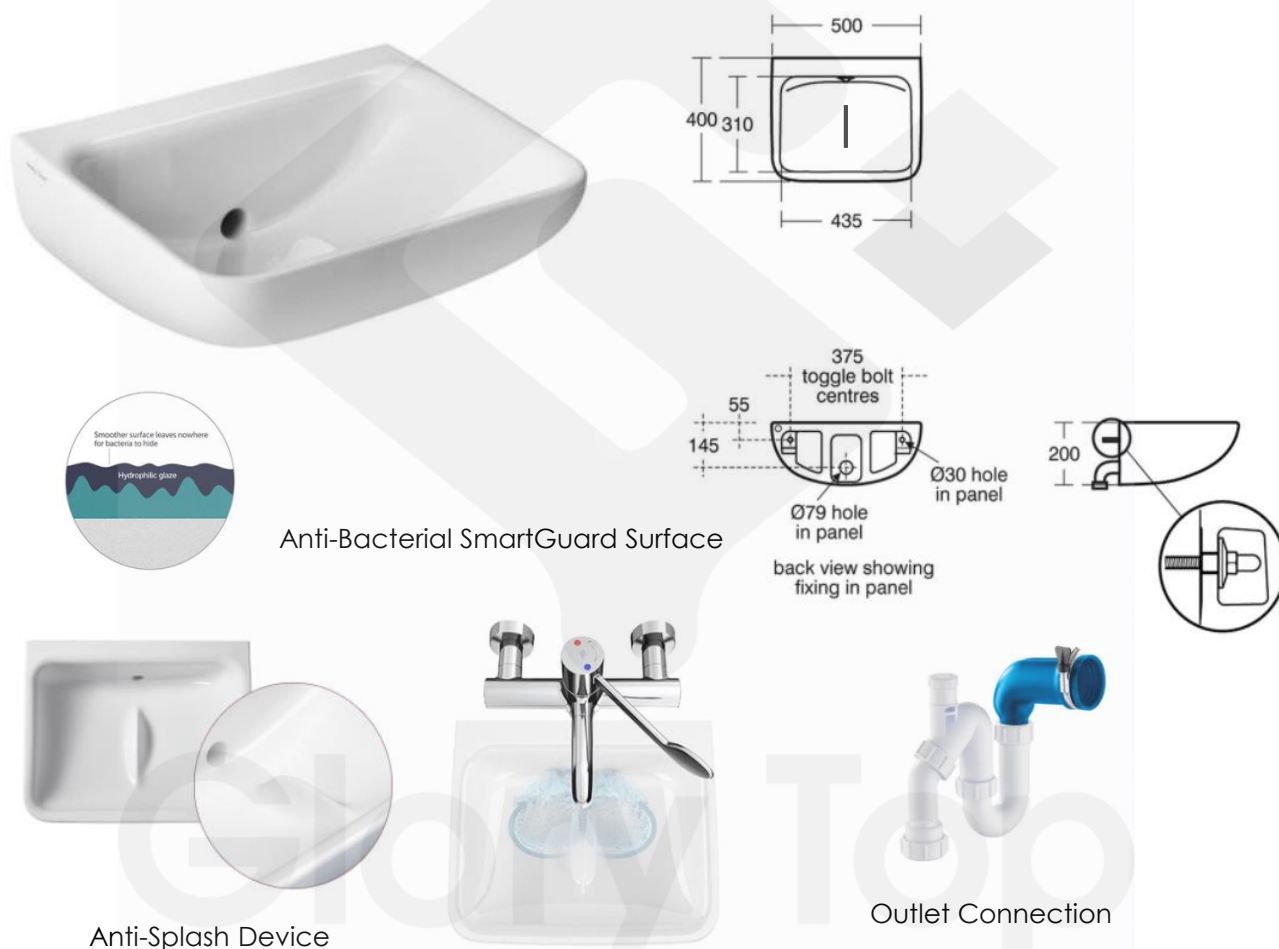

## Remarks:

SmartGuard coating - Anti-bacterial Hydrophobic glaze.

Anti-splash "fin" feature. HBN 00-10 HTM64-2006 listed. Vitreous china to BS3402. Washbasin to BS EN 14688 and BS EN 31.

Antibacterial test to MOD ISO 22196.

Trap pack to BSEN274-1 & BSEN274-2

## Product Details

<b>Brand</b>	Armitage Shanks	<b>Dimension</b>	500 x 400 x 200mm
<b>Materials</b>	Vitreous China	<b>Country of Origin</b>	United Kingdom (UK)
<b>Finish</b>	SmartGuard - White	<b>WELS</b>	-
		<b>WSD Ref. No.</b>	-
		<b>Expiry Date</b>	-

\* Information provided above is for reference only and is subject to change without prior notice.



Glory Top Building Materials Ltd  
Glory Top Architectural Hardware Ltd  
高晉建築材料有限公司  
高晉五金建材有限公司

T | 3583 8333  
E | Info@glorytop.com.hk  
W | www.glorytop.com.hk  
A | 15/F, 8 Jordan Road, Kowloon